

# BACKBOARD MOUNTING INSTRUCTIONS

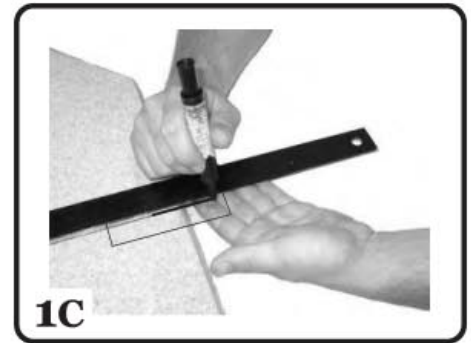
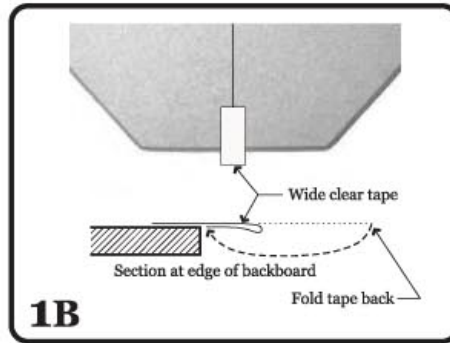
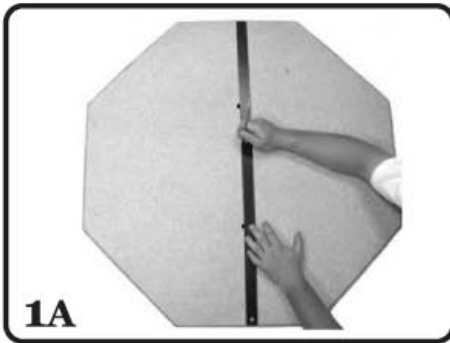

## STEP 1: Establish plumb line on back of board

Place the backboard fabric side down on a stable surface. Use a straightedge and pencil or marker to draw a line extending through the centers of the mounting holes to both edges of the backboard.

Adhere a piece of wide clear tape to the edge of the backboard at the ends of the line drawn in step "1A" allowing 3 inches of tape to extend past the edge. Fold the extending tape back onto itself so that a 1-1/2 inch long double-thick tape extension results.

While supporting the underside of the 1-1/2 inch long tape extension applied in "1B," continue the line drawn in step "1A" onto the tape extension using a permanent marker and straightedge.

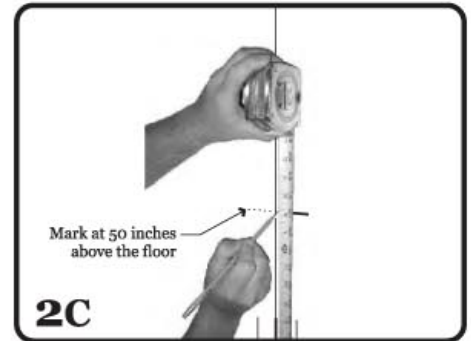
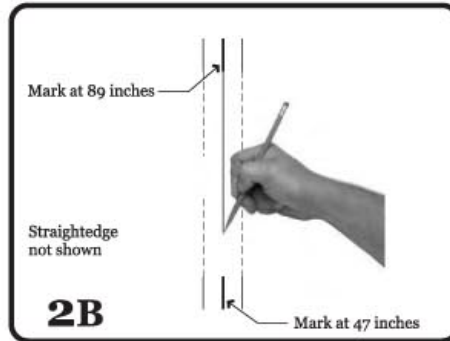
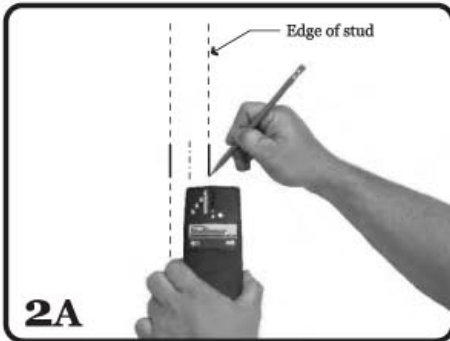

## STEP 2: Establish plumb line and mounting height on wall

Using a stud-finder, locate a wood stud at the wall where the backboard is to be mounted. This will be the center of the backboard. Draw a mark at the centerline of the stud at 47 inches and 89 inches above the floor.

Using a straightedge and pencil, draw a plumb line on the wall connecting the two marks drawn in step "2A." For more accuracy, use a level to check the marks for plumb.

Draw a horizontal mark at 50 inches above the floor across the mark drawn in the last step. Aligning the bottom of the backboard with this mark positions the bull's eye of the dart board at the standard height of 5 feet 8 inches above the floor.

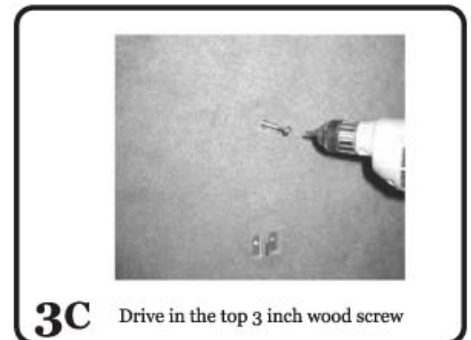
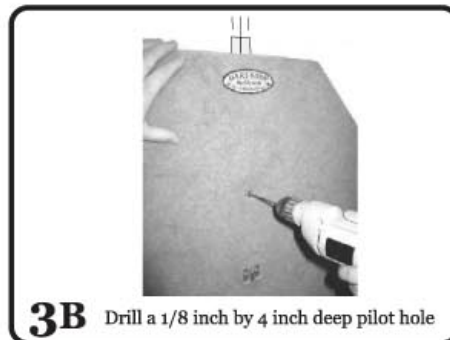
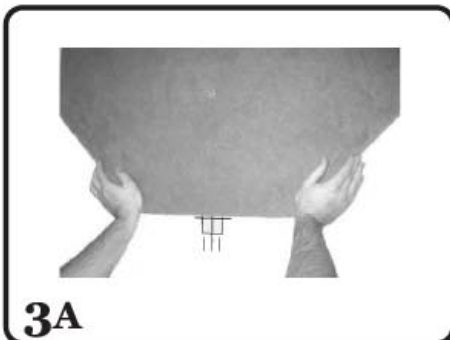

## STEP 3: Drill holes in stud and fasten board to wall (two people required)

Position the backboard on the wall with the bottom of the backboard aligned with the 50 inch high mark from "2C." Align the marked tape extensions with the vertical line drawn in step "2B." This will position the backboard plumb.

Maintaining alignments per "3A," one person firmly holds the backboard while the second person drills a 1/8 by 4 inch deep pilot hole at the top mounting hole. While the first person continues to hold the backboard, the second person drives in the provided 3 inch long wood screw\*.

For the lower hole, repeat the procedure described in "3B." This step completes the backboard mounting instructions.

\* Tape extensions are easier to remove if the screws are not completely driven.

**NOTICE:** These mounting instructions apply to conventional wood-framed construction. For other types of construction, you may need to consult a construction professional. **WARNING:** To avoid personal injury, backboard or property damage, assure that both mounting screws fully engage the wood stud. **DISCLAIMER:** Dart-Stop Backboards will not be responsible for damages, including but not limited to personal injury due to failure to comply with printed Backboard Mounting Instructions